



# Parts and Accessories. Installation Instructions.

## TV function retrofit kit BMW Z4 (E85)

**These installation instructions are only valid for cars with SA 609 (navigation system)**

**Retrofit kit No.**          65 50 304,675

### Installation time

The installation time is 3.0 hours, but this may vary depending on the condition of the car and the equipment in it.

### Important information

These installation instructions are primarily designed for use within the BMW dealership organisation and by authorised BMW service companies.

In any event the target group for these installation instructions is specialist personnel trained on BMW cars with the appropriate specialist knowledge.

All work must be completed using the latest BMW repair manuals, circuit diagrams, servicing manuals and work instructions in a rational order using the prescribed tools (special tools) and observing current health and safety regulations.

Ensure that the cables/lines are not kinked or damaged as you install them in the car. The costs incurred as a result of this will not be reimbursed by BMW AG.

Additional cables/lines that you install must be secured with cable ties.

If the specified PIN chambers are occupied, bridges, double crimps or twin-lead terminals must be used.

All the figures show LHD cars, proceed in exactly the same way on RHD cars.

Pictograms



Denotes instructions that draw your attention to dangers.



Denotes instructions that draw your attention to special features.

◀ denotes the end of the instruction or other text.

See the EBA CD or Aftersales Portal for explanations of the pictograms.

Do not archive the hard copy of these installation instructions since daily updates are made by Aftersales Portal.

Subject to technical modifications.

**Installation information**

Some of the installation of the aerial is shown only on the left-hand side of the car, proceed in the same way on the right-hand side of the car.

**Ordering instructions**

The boot bulkhead trim is not included in the installation kit and must be ordered separately (see EPC for part number).

**List of special equipment**

The following special equipment must be taken into consideration when installing the retrofit kit:

**SA 609** Navigation system

**Information on operation**

The TV function is only active when the car is at a standstill.

**Special tools required**

65 5 400 Release bar

## Contents

Section	Page
1. Parts list .....	4
2. Preparations.....	5
3. Connection diagram.....	6
4. Installation and cabling diagram .....	7
5. To install the video module and connect the adapter cable .....	8
6. To install and connect the bumper aerial .....	11
7. Concluding work and coding .....	13
8. Circuit diagram .....	14

## 1. Parts list

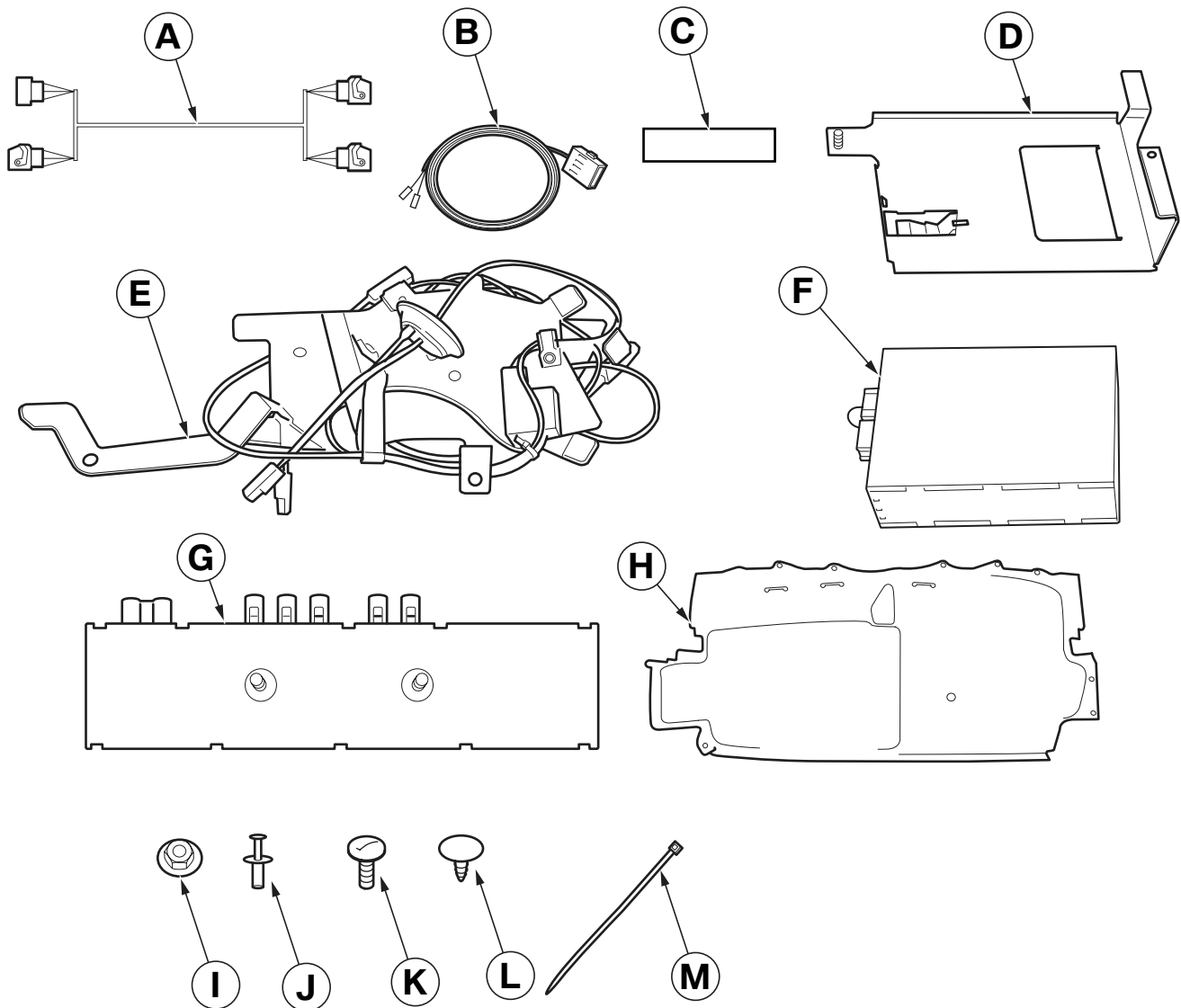

085 0134 Z

### Legend

- A Adapter cable
- B Aerial cable
- C Felt
- D Video module holder
- E Bumper aerial
- F Video module
- G Aerial booster
- H Boot trim (not included in kit)
- I Hexagonal nut with washer M5 (4x)
- J Securing rivet for the TV aerial (8x)
- K Press-stud (4x)
- L Clip (2x)
- M Cable tie (15x)

## 2. Preparations

	<b>TIS No.</b>
Conduct a brief test	---
Disconnect the negative pole of the battery	12 00 ...
<b>The following components must be removed first of all</b>	
Rear bumper trim	51 12 156
Left boot – wheel arch trim	51 47 151
Aerial booster	65 20 110
Trim for boot bulkhead	51 47 140
Flap on the rear oddments box	51 16 239
Trim for rear storage box	51 16 235
Navigation computer	65 90 140

### 3. Connection diagram

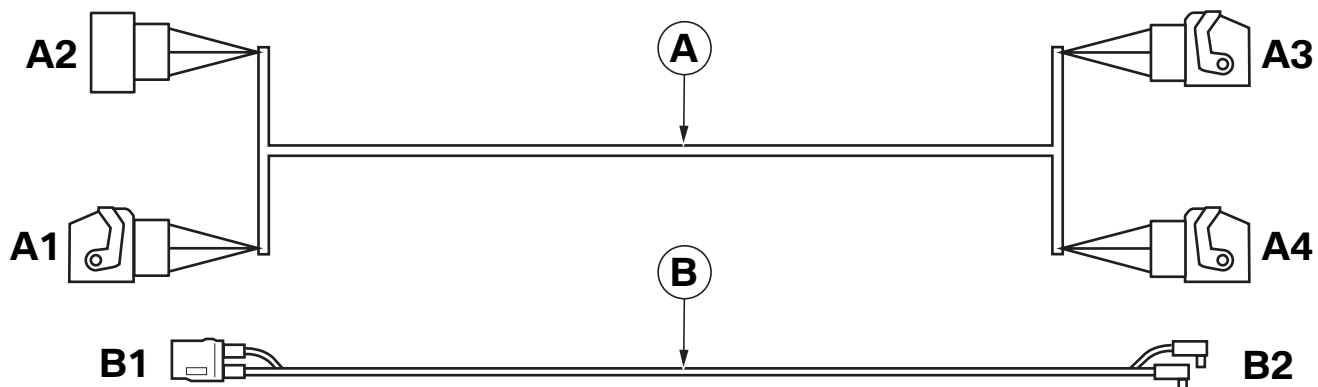

085 0135 Z

Item	Description	Signal	Cable colour / Cross-section	Connection location in the car	Abbreviation / Slot
A	Adapter cable	---	---	---	---
A1	18-pin BL socket casing	---	---	To navigation computer <b>A112</b>	X1313
A2	18-pin BL plug casing	---	---	To standard wiring harness plug, 18-pin BL socket casing	X1313
A3	WS 18-pin socket casing	---	---	To video module holder <b>A197</b>	X18804
A4	18-pin BL socket casing	---	---	To video module <b>A197</b>	X18806
B	Aerial cable	---	---	Between aerial booster and video module <b>A197</b>	---
B1	Aerial plug, 2-pin SW	---	---	To the aerial booster	---
B2	Angle plug	---	---	To video module <b>A197</b>	---

## 4. Installation and cabling diagram

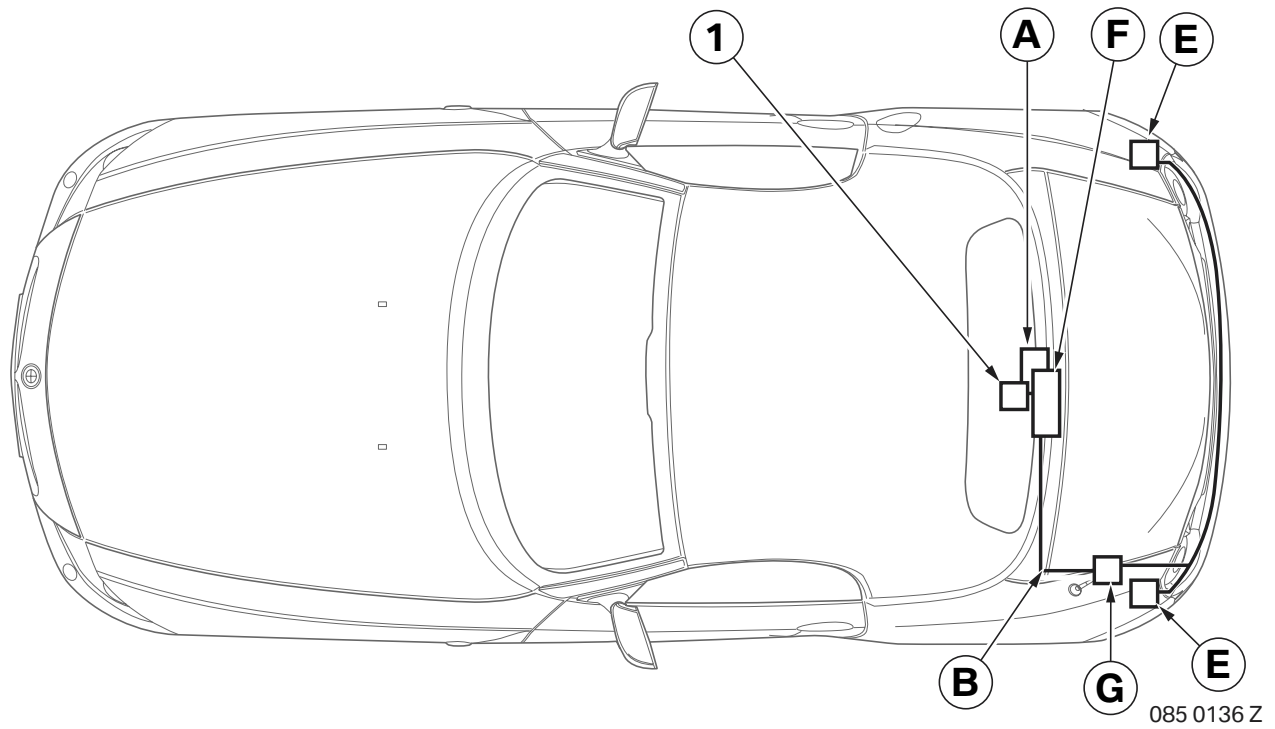

### Legend

- A Adapter cable
- B Aerial cable
- E Bumper aerials
- F Video module
- G Aerial booster
  
- 1 Navigation computer

## 5. To install the video module and connect the adapter cable

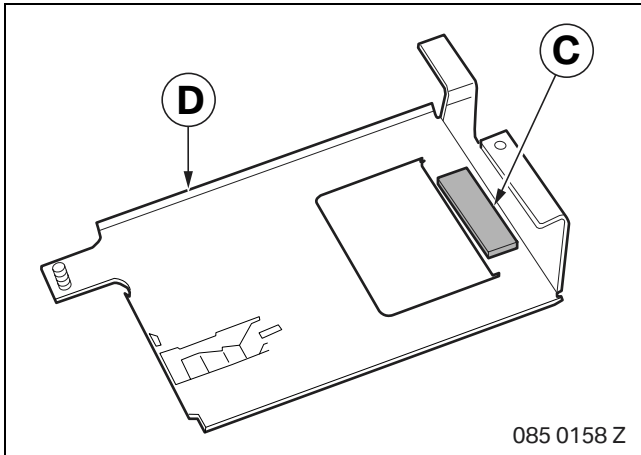

Affix the felt **C** to the holder **D**.

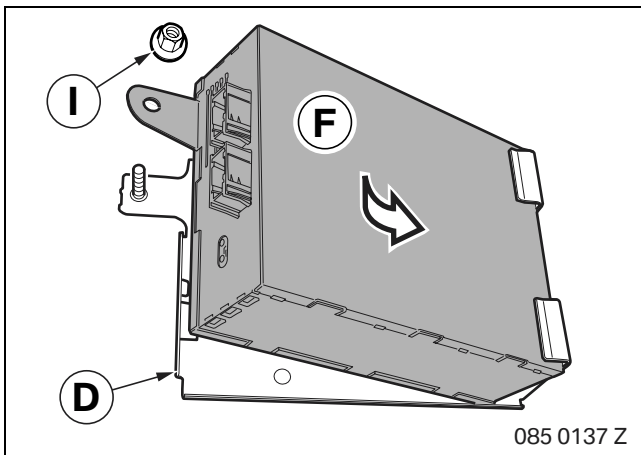

Insert the video module **F** into the holder **D** and secure it with a hexagonal nut **I**.

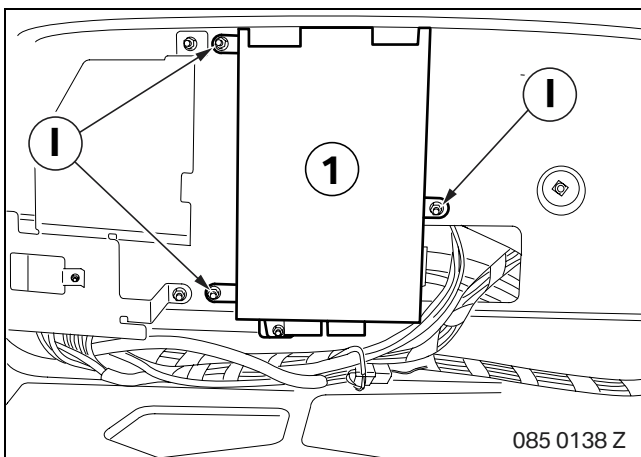

Place the video module and holder (1) on the stud bolt and secure it with a hexagonal nut **I**.

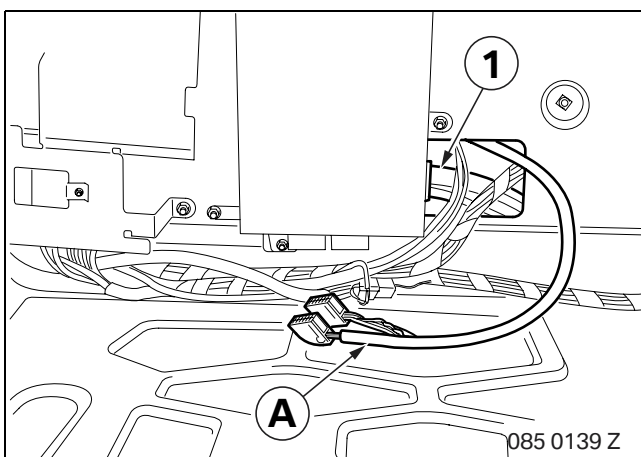

Thread the adapter cable **A** through the opening (1) into the interior.



5. To install the video module and connect the adapter cable

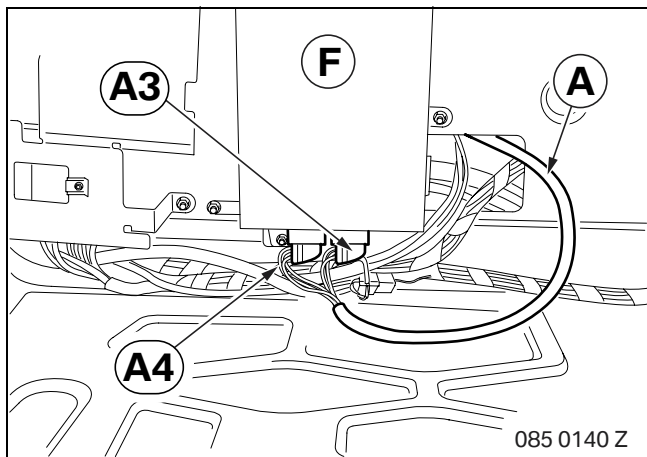

Connect branches **A3** and **A4** on the adapter cable **A** to the same coloured cables on the video module **F**.

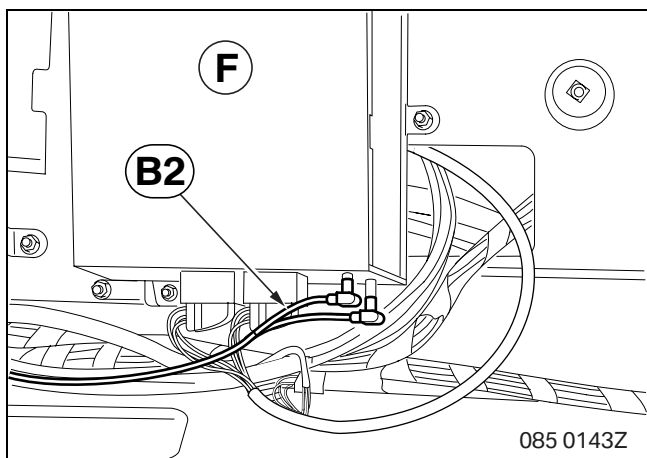

Connect branch **B2** to the video module **F**.

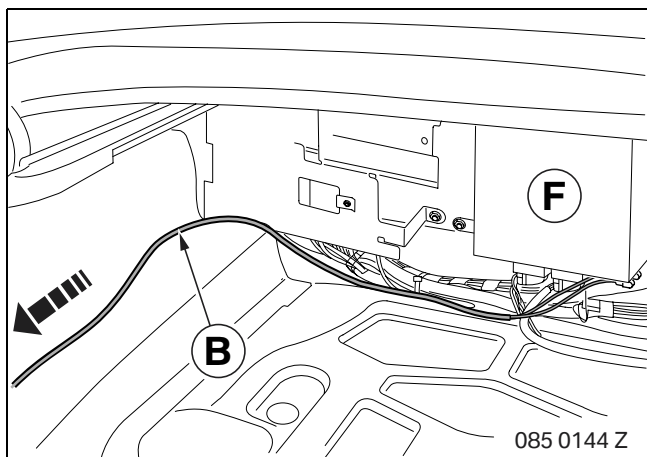

Route the aerial cable **B** from the video module **F** to the rear closing panel.

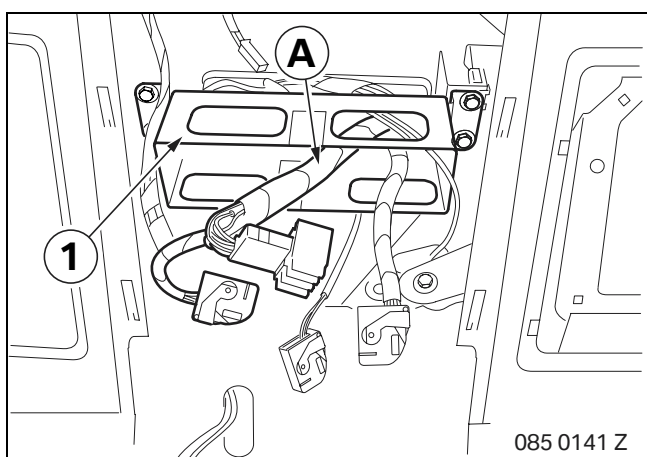

Route the adapter cable **A** through the holder for the navigation computer (1).

5. To install the video module and connect the adapter cable

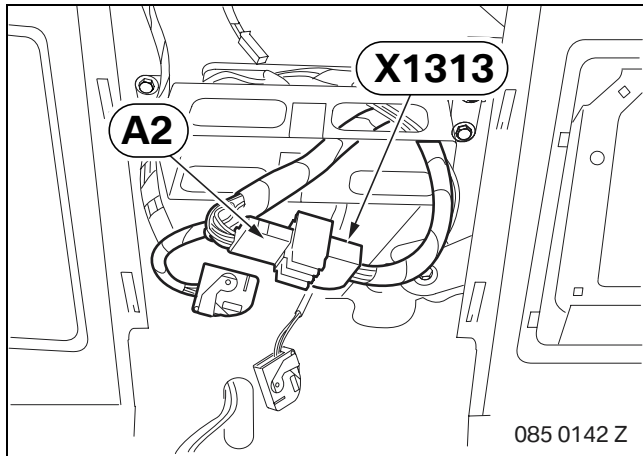

Connect branch **A2** to plug **X1313**, BL from the navigation computer.

## 6. To install and connect the bumper aerial

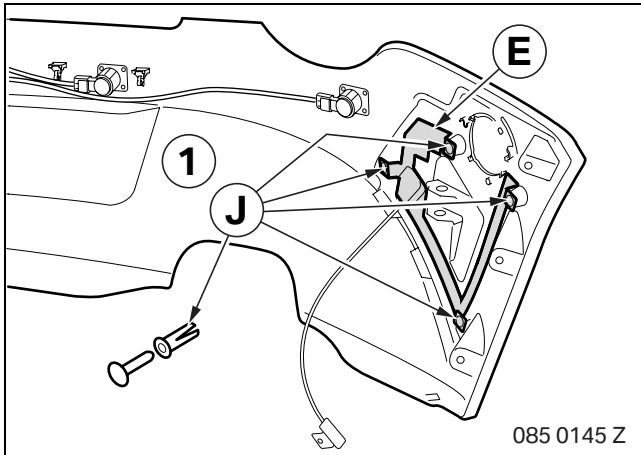

Secure the bumper aerial **E** on the bumper trim (1) with fastening rivets **J**.

Install the bumper aerial **E** on both sides.

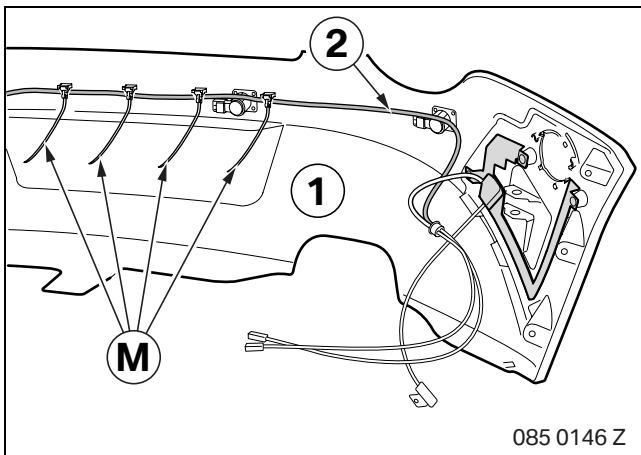

Secure the connection cable (2) on the bumper trim using cable ties **M**.

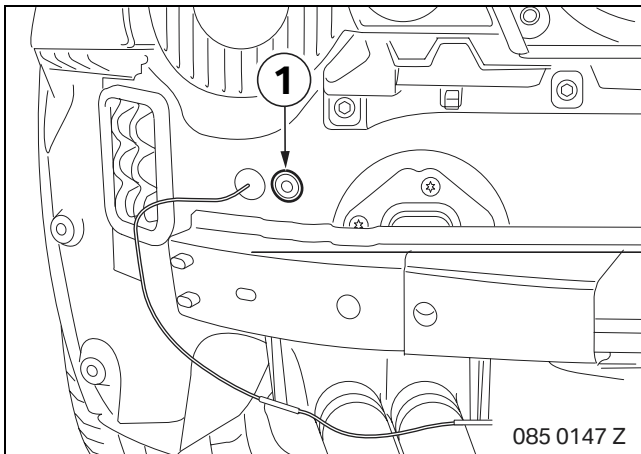

Remove the sealing stopper (1).

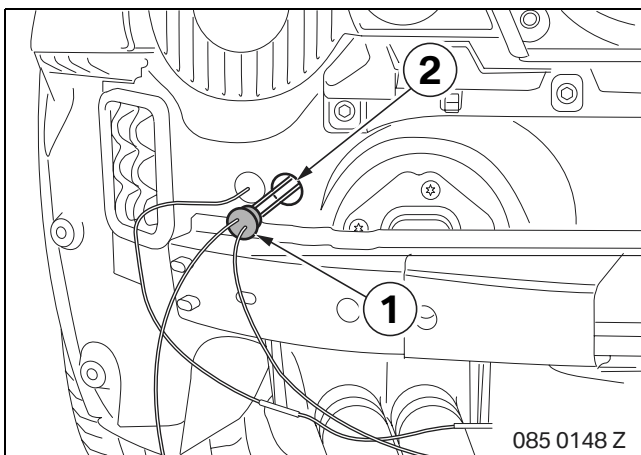

Press the aerial cable through the holder (2) into the boot and push in the sealing stopper (1).

6. To install and connect the bumper aerial

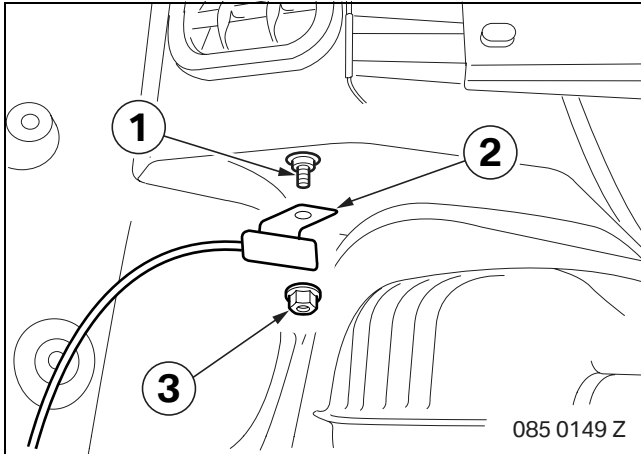

▶ Proceed in exactly the same way on the right-hand side. ◀

Screw the nut and washer (3) from the earth stud (1).

Screw the aerial capacitor (2) to the earth stud (1) using a nut and washer (3).

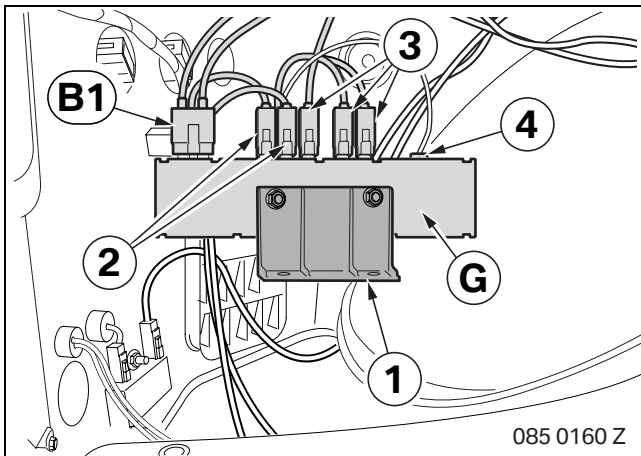

Bolt the holder (1) to the aerial booster **G**.

Connect the aerial cable (3) and radio-on signal (4) to the same coloured cables on the aerial booster **G**.

Connect branch **B1** and the aerial cables for the bumper aerial (2) to the same coloured cables on the aerial booster **G**.

## 7. Concluding work and coding

- Connect the battery
- Code the retrofit using DISPlus, MoDiC III or GT-1 via path **Retrofit**
- Conduct a brief test
- Conduct a function test
- Re-assemble the car.

# 8. Circuit diagram

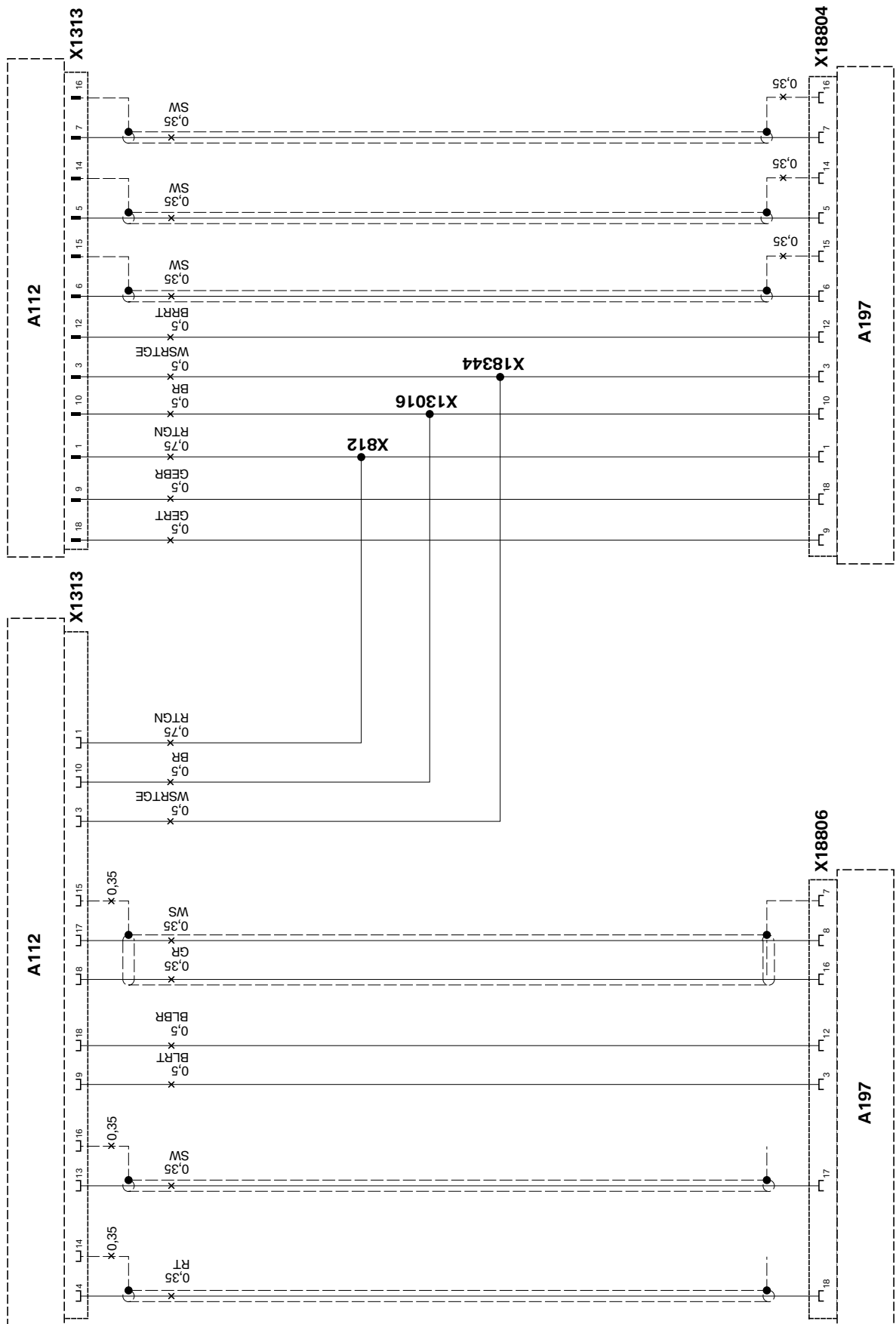

085 0153 Z

## 8. Circuit diagram

### Legend

**A112** Navigation computer

**A197** Video module

**X812** Terminal 30 connector

**X1313** 18-pin plug

**X13016** Earth connector

**X18344** I bus connector

**X18804** 18-pin plug

**X18806** 18-pin plug

### Cable colours

BR Brown

GE Yellow

GN Green

GR Grey

RT Red

SW Black

VI Violet

WS White