



Parts and Accessories Installation Instructions

Illuminated Door Sill Strips Retrofit BMW Z4 (E85)

Important information

Only for use in the BMW dealer organisation.

Ensure that the cables/lines are not kinked or damaged as you install them in the car.

If the specified PIN numbers are occupied, bridges, double crimps or twin-lead terminals must be used.

Some of the work is only shown on one side of the car. Proceed in exactly the same way on the other side of the car.

Subject to technical modifications.

Target group

The target group for these installation instructions is specialist personnel trained on BMW cars with the appropriate specialist knowledge.

All work must be completed using the latest repair manuals, circuit diagrams, servicing manuals and work instructions in a rational order using the prescribed tools (special tools) and observing current health and safety regulations.

The installation time is approx. 1.25 hours, but this may vary depending on the condition of the car and the equipment in it.

Retrofit kit No.: 51 47 0 149 210

Special tools required

None

Contents

Section	Page
1. Preparations.....	3
2. Parts kit.....	4
3. To install the retrofit.....	5
4. Concluding work and coding.....	7

1. Preparations

	TIS instruction No.
Conduct a brief test	
Disconnect the negative pole of the battery	12 00 ...
The following components must be removed first of all:	
Cover trim on left and right door sill	51 47 065
Door sill strip (interior) left and right	51 47 000
Pedal trim	51 45 185
Trim below glove compartment on the right	51
Side footwell trim on the left A pillar	51 43 070
Side footwell trim on the right A pillar	51 43 075

2. Parts kit

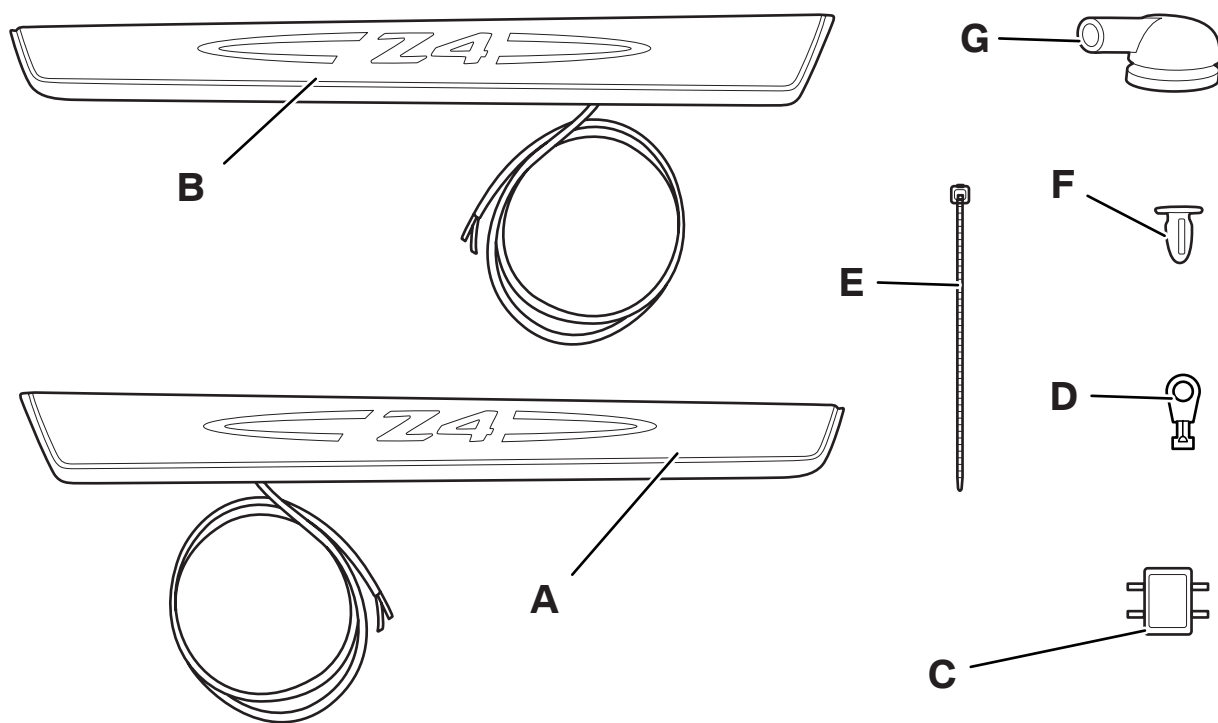

085 0001 V

Legend

- | | | | |
|---|---|---|-----------------|
| A | Illuminated door sill strip, left (1x) | E | Cable tie (10x) |
| B | Illuminated door sill strip, right (1x) | F | Clip (6x) |
| C | Insulation-piercing connector (2x) | G | Grommet (2x) |
| D | Ring cable lug (2x) | | |

3. To install the retrofit

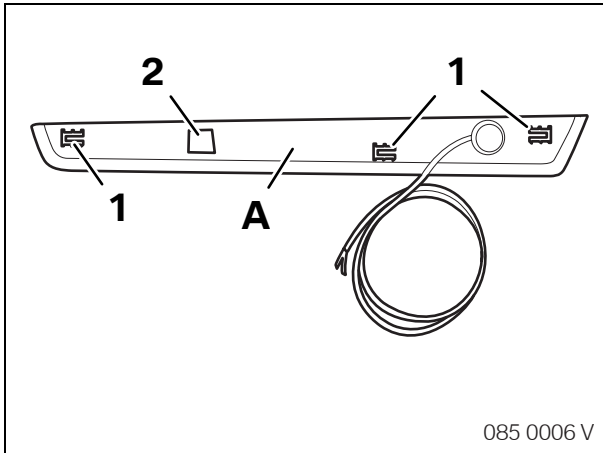

Insert the clips **F** into the mountings (1) of the illuminated left door sill strip **A**.

Remove the backing foil from the Velcro fastener (2).

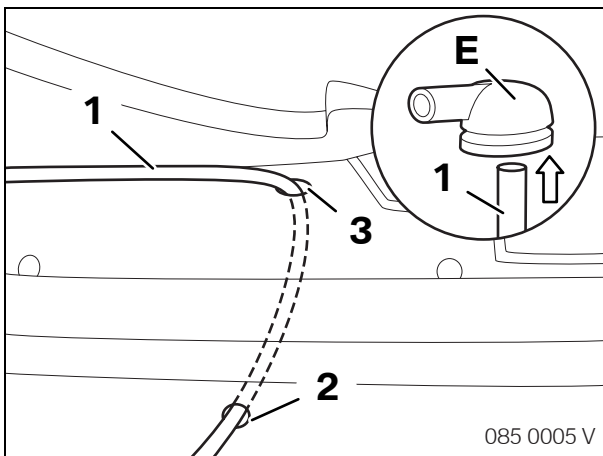

Clean the side skirt to ensure good adhesion of the Velcro fastener. Carefully clip on the illuminated left door sill strip **A** along its entire length, making sure that the metal cover does not bend. ◀

Route the cable (1) through the holes (2) and (3) into the vehicle interior. (Hole (2) is the third hole from the front in the side skirt.)

Insert the cable (1) into the grommet **G** and insert the grommet **G** into the hole (3).

Fit the illuminated left door sill strip **A** and press down firmly in the area of the Velcro fastener.

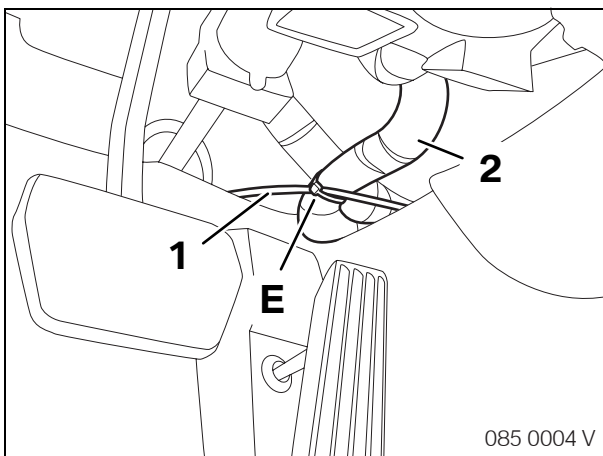

Route the cable (1) forwards to the left A pillar, then behind the centre console into the right footwell.



Use cable ties **E** to connect the cable (1) to the standard wiring harness (2). ◀

Install the illuminated right door sill strip **B** in the same way.

Route the cable to the right A pillar.

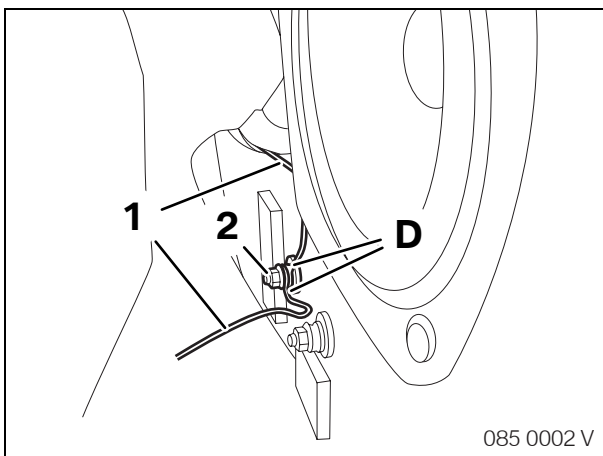

Strip the black insulation from the cables back to a sufficient length. ◀

Strip the insulation off the brown earth cables (1) and crimp-connect the ring cable lugs **D**.

Attach the ring cable lugs **D** to the earth bolt **X9634 (2)**.

3. To install the retrofit

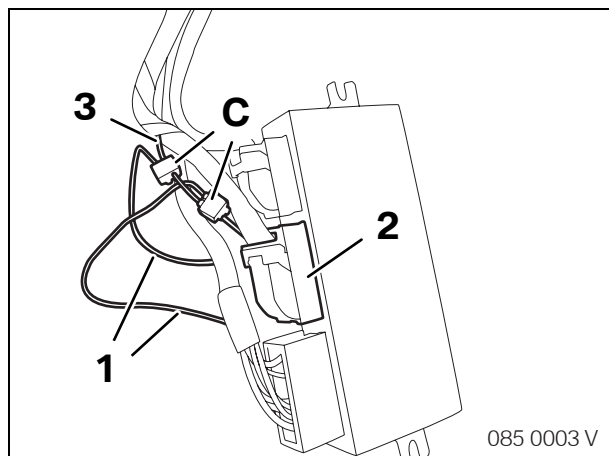

▶ Undo the base module 5 from the trim underneath the glove compartment. ◀

Route the yellow cables (1) to the central plug (2) on the base module 5. Use insulation-piercing connectors **C** to connect to the red/blue cable (3) on pin 18.

4. Concluding work and coding



The illuminated door sill strips retrofit does not require coding. ◀

- Connect the battery, connect a charger
- **Perform a function test in dim light**, since the illuminated door sill strips are difficult to see in bright light
- Re-assemble the car